



# INLINE BOOTH RENTALS

**Archery Trade Association**

**G136020122**

Kentucky Exposition Center | Louisville, KY

January 7 - 9, 2022

## ONLINE & DISCOUNT DEADLINE:\* WEDNESDAY, DECEMBER 8, 2021

\* Order with complete Method of Payment must be received before Discount Deadline date to receive discounted pricing. Additional Rush charges may be applied to orders placed after deadline or on-site.

### Turnkey Rental Designs Make Exhibiting Easier!

**Carpet and Electricity not included.** Please order as needed. All Exhibit Booth Rentals include installation/dismantling and graphic panels as shown for print-ready graphics. If graphics submitted are not print-ready, additional fees may apply. Monitor and lighting options available.

Don't see what you are looking for or need a tweak to a design? Let one of our incredible designers create a space just for you! Please contact an Exhibit Team member with any questions or customization requests.

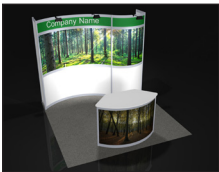

The Eddie



The Jonathon

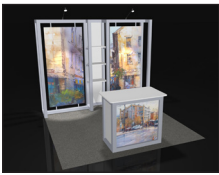

The Pierce

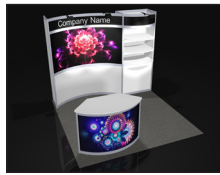

The Madison



The Grant

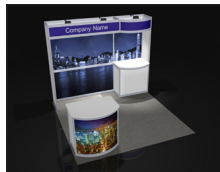

The Harrison

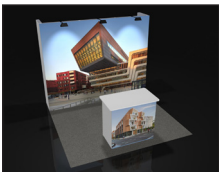

The Hamilton

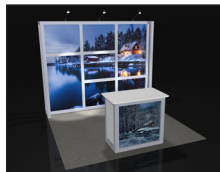

The Lucy

### Inline Booths

CODE	ITEM	QTY	ONLINE	DISCOUNT	REGULAR	TOTAL
66470	The Eddie - 10' x 10'		\$2,798.05	\$3,217.75	\$3,603.90	
66471	The Eddie - 10' x 20'		\$4,556.55	\$5,240.05	\$5,868.85	

CODE	ITEM	QTY	ONLINE	DISCOUNT	REGULAR	TOTAL
66474	The Jonathon - 10' x 10'		\$1,952.05	\$2,244.85	\$2,514.25	
66475	The Jonathon - 10' x 20'		\$3,416.85	\$3,929.40	\$4,400.95	

CODE	ITEM	QTY	ONLINE	DISCOUNT	REGULAR	TOTAL
66477	The Pierce - 10' x 10'		\$2,421.30	\$2,784.50	\$3,118.65	
66478	The Pierce - 10' x 20'		\$4,597.30	\$5,286.90	\$5,921.35	

CODE	ITEM	QTY	ONLINE	DISCOUNT	REGULAR	TOTAL
66484	The Madison - 10' x 10'		\$2,936.20	\$3,376.65	\$3,781.85	
66485	The Madison - 10' x 20'		\$3,479.95	\$4,001.95	\$4,482.20	

CODE	ITEM	QTY	ONLINE	DISCOUNT	REGULAR	TOTAL
66486	The Grant - 10' x 10'		\$3,099.35	\$3,564.25	\$3,991.95	
66487	The Grant - 10' x 20'		\$4,295.55	\$4,939.90	\$5,532.70	

CODE	ITEM	QTY	ONLINE	DISCOUNT	REGULAR	TOTAL
66492	The Harrison - 10' x 10'		\$2,849.20	\$3,276.60	\$3,669.80	
66493	The Harrison - 10' x 20'		\$4,186.85	\$4,814.90	\$5,392.70	

CODE	ITEM	QTY	ONLINE	DISCOUNT	REGULAR	TOTAL
66467	The Hamilton - 10' x 10'		\$2,288.80	\$2,632.10	\$2,947.95	
66468	The Hamilton - 10' x 20'		\$4,009.65	\$4,611.10	\$5,164.45	

CODE	ITEM	QTY	ONLINE	DISCOUNT	REGULAR	TOTAL
66473	The Lucy - 10' x 10'		\$1,794.35	\$2,063.50	\$2,311.10	

<b>TOTAL ESTIMATE</b>	\$ _____
<b>TAX</b> (All tax rates are subject to change)	6.00%
<b>AMOUNT DUE</b>	\$ _____

Submission of this form indicates you read and accept the Payment Policy and Terms & Conditions. All orders cancelled by the exhibitor within 30 days of first day of exhibitor move in day may be subject to cancellation fees up to 100% of the total order, based upon the status of move-in, work performed and/or Shepard set-up costs or expenses.

COMPANY NAME: \_\_\_\_\_ BOOTH NUMBER: \_\_\_\_\_

CONTACT NAME: \_\_\_\_\_

EMAIL ADDRESS: \_\_\_\_\_



Email completed form to: [exhibits@shepardes.com](mailto:exhibits@shepardes.com)

[shepardes.com](http://shepardes.com)